

Operating Instructions

TSE Basic





Made in Germany
www.burg-waechter.de



SecuTronic Basic

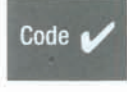
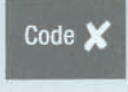

Key:

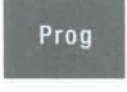
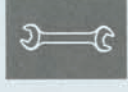
 Key function control	 Code input correct	 Code input incorrect	 Manipulation block (5 min thereafter 20 min)	 Please replace batteries	 Program mode	 Maintenance required (see technical data)
-----------------------------------------------------------------------------------------------------------	---------------------------------------------------------------------------------------------------------	-----------------------------------------------------------------------------------------------------------	--------------------------------------------------------------------------------------------------------------------------------------	----------------------------------------------------------------------------------------------------------------	-----------------------------------------------------------------------------------------------------	---------------------------------------------------------------------------------------------------------------------------------------

Opening the safe:

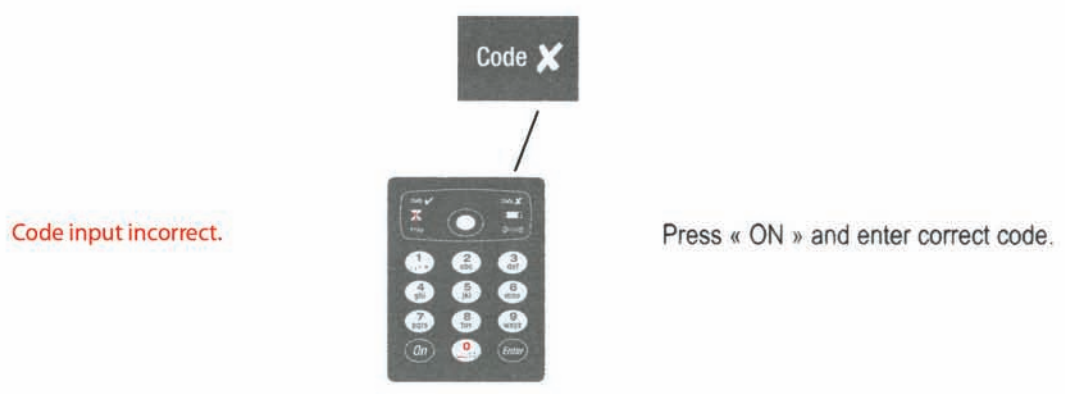
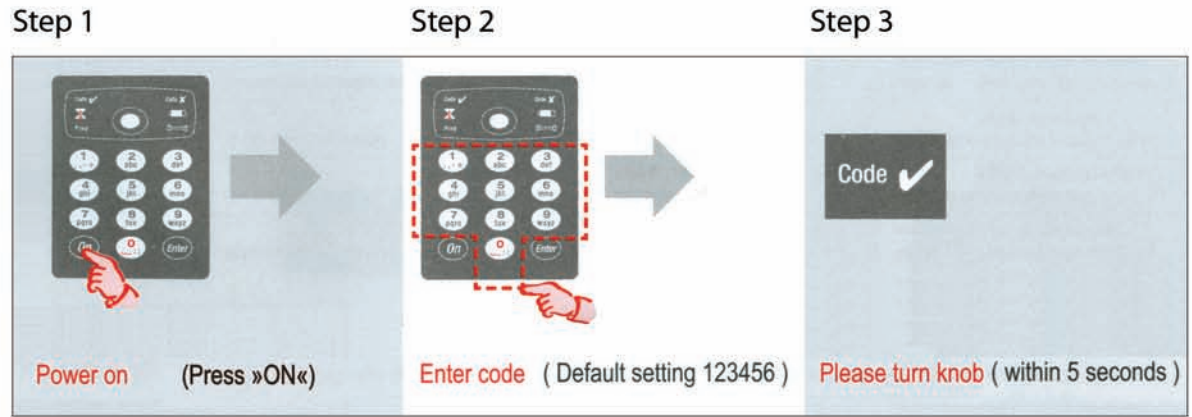

Changing Codes:

Important

Enter code changes only with door open !

Do not enter personal data (e.g. birth date, telephone no.)

Step 1

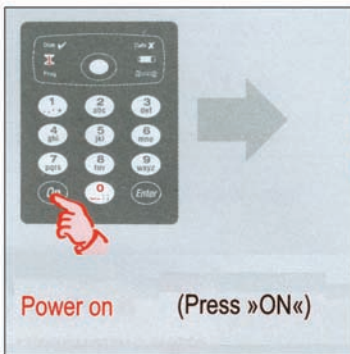

Step 2



Step 3

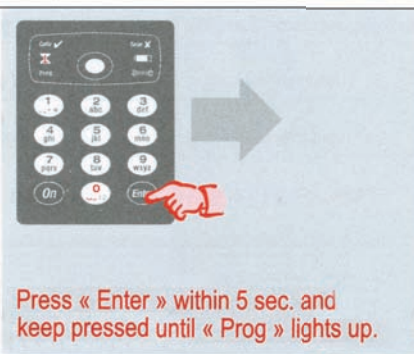

Step 4



Step 5



Step 6



Step 7



Step 8

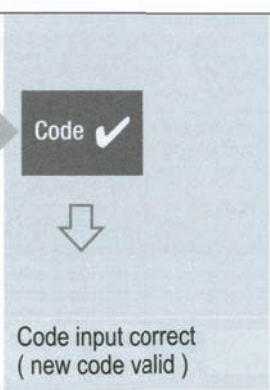

Step 9

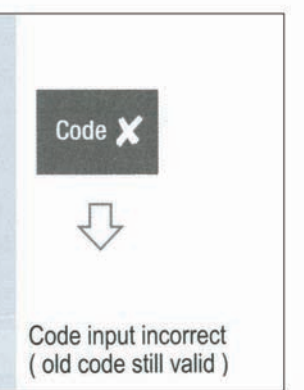



**BURG
WÄCHTER**

BURG-WÄCHTER KG

Altenhofer Weg 15
D-58300 Wetter
Germany

www.burg-waechter.de
info@burg-waechter.de

BA-TSE Basic / SecuTronic Basic - NM 10/03

Technical Information:

Technical data

SecuTronic 8 Basic:
Electronic lock as per EN 1300 Class: B
Combination lock with 1.000.000 real possibilities.

6-digit code

Manipulation block
(block active if wrong code entered 3 times):
TSE 3000 Basic: 1 min., thereafter 3 min.
SecuTronic Basic: 5 min., thereafter 20 min.

Power supply:
TSE 3000 Basic: 3 MIGNON batteries, LR6, AA, alkaline
SecuTronic Basic: 3 MICRO batteries, LR03, AAA, alkaline

Maintenance required:
The system has established maintenance requirement.
Please contact your local dealer.

Optimal environmental conditions:
-15°C / +40°C / up to 95% relative humidity
(no condensation)

Permitted temperature range: -20°C / +50°C

When installed on external doors, the TSE 3000 Basic should be protected from constant exposure to the elements (e.g. by a canopy).

Typographical errors, omissions and changes reserved.

Changing Batteries:

Battery replacement



Dispose batteries in an environmentally safe manner.

SecuTronic Basic

